

CERTIFIED RECORD OF LAND CORNER MONUMENTATION

AMMENDED - Mar. 19, 1982

History of original corner establishment:

Original corner established by Barnford Robb under joint contract of Robb & Eckelson number 366, dated August 18, 1880.

Surveyor General's record states:

Set a basalt stone 12x8x6 for 1/4 sec. cor. from which

- A pine 36 ins diam bears S. 10°E. 62 lks distant
- A pine 24 ins diam bears N. 30°W. 45 lks distant

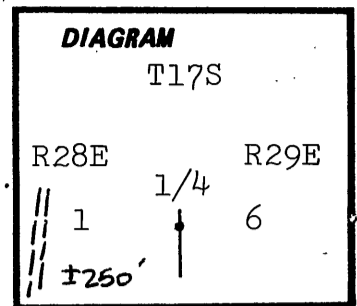

Description of corner evidence found:

I found a lone rock 12x8x6 marked 1/4 on the south face with a wooden hub alongside.

No evidence of original BT's except a stump hole S. 10° E. 45'± distant with old rotten stump and logs nearby. A rotted tree lies North with stump location in middle of skid trail, N. 30°W. approximately 30' distant.

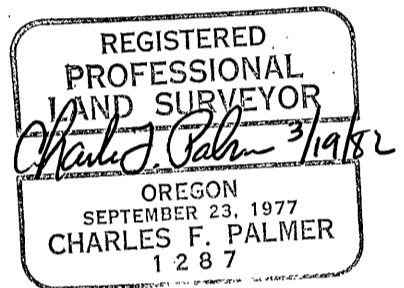

Description of monument and accessories established to perpetuate the original location of this corner:

At the location of the marked stone I set a standard F.S. Aluminum monument consisting of a 3" disk mounted on a 2x30" pipe with a 4x4 1/2" footplate, buried 24" deep with 6" protruding above the ground. The original marked stone is buried alongside. The disk is stamped as shown:

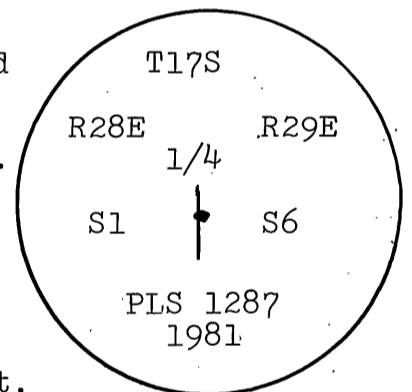

New BT's:

- A 9" pine bears N. 45°E. a distance of 7.0 feet, scribed 1/4S6 BT
- A 12" pine bears N. 73°30' W. a distance of 5.9 feet, scribed 1/4S1 BT

Both banded with red paint, have BT and Attention signs and have a brass disk stamped PLS 1287 nailed at the base of the BT blaze.

Monument set 10/20/81

Witnesses: H.W. Palmer
P. Zabala

Monument set as part of U.S. Forest Service "Three Piece" cadastral survey, see Survey Plat dated Nov. 1981, Grant County Survey No. 708.

Office of.....Surveyor..... County of.....Grant.....
 State of...Oregon....., I hereby certify that the within instrument was filed in this office
 for record on the 23 day of March, 1982
Robert D. Baggett by
 (COUNTY OFFICIAL) (DEPUTY)

*Supersedes remon sheet
filed 12-18-81*